

Biomax[®]
INTERNATIONAL X

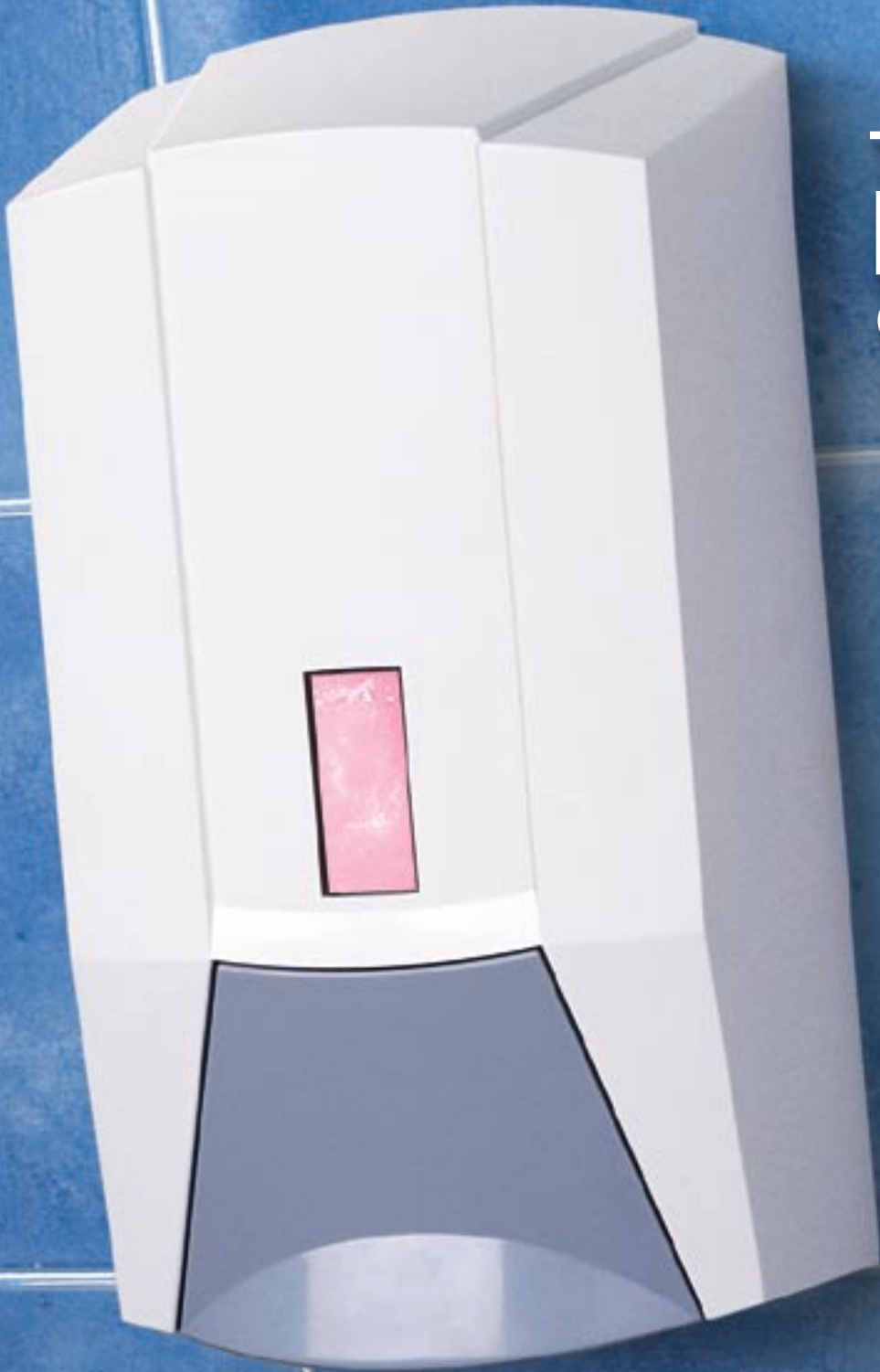

The
New
Generation
of **Skin**
Care
Systems

Avmor[®]

The Complete Biomaxx INTERNATIONAL SKIN CARE SYSTEM

- SOAP DISPENSER
- PREMIUM SKIN CARE PRODUCTS

The BIOMAXX INTERNATIONAL skin care system offers the latest in bag-in-box technology and design. Bag-in-box is the clear choice of professionals for dispensing systems...



Box Design
Patent Pending

More Hygienic

Unlike bulk systems, bag-in-box provides hermetically sealed bags and individual pumps enhancing germ-free applications. Both features help prevent dermatitis – causing germs from contaminating your soap.

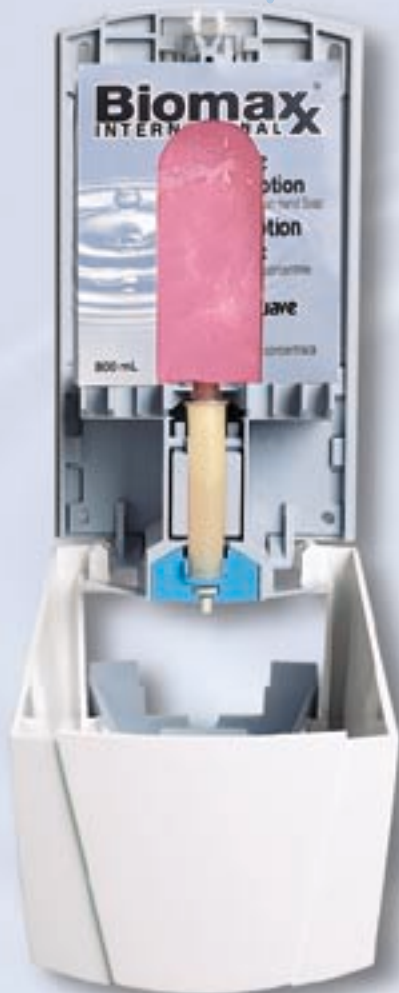

Greater Convenience

800 ml standard refill box means the dispenser is easy to load and maintain.

Cleaner Environment

Refills are virtually mess-free and spill-proof. There are no bulky containers to throw away or create a mess with cumbersome refills. No leaks or mess means a tidy appearance and sanitary environment.

Superior Quality

Of course, the system is complete with our family of BIOMAXX INTERNATIONAL brand premium quality soaps and lotions.

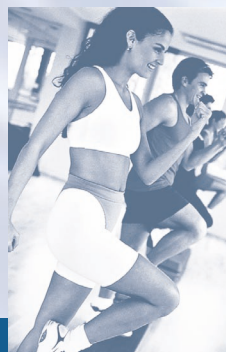
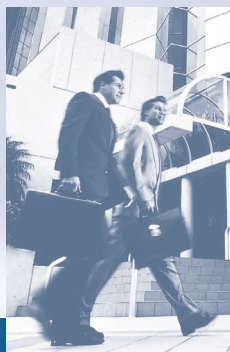

**THE CHOICE OF PROFESSIONALS...
skin care systems for all environments!**

The New

DISPENSER

FEATURES

Compact

This "space-saving" dispenser uses the minimal amount of wall space, fits into places where other dispensers will not go and complies with the American Disability Act (ADA).

High Quality Attractive Design

Timeless and elegant in appearance, the state-of-the-art design incorporates many practical features that allow easy cleaning and low maintenance. Available in a high gloss finish with no difficult, hard-to-reach corners, and sloped surfaces that do not collect dirt or cigarettes.

High ABS Construction

A high-impact, scratch-resistant ABS construction enhances the dispenser's durability and provides a wipe-clean surface.

Convenient Push Mechanism

Reinforces the dispenser's mounting to the wall with every push. Easy to maintain a neat professional appearance.

Economical Portion Control

Realizes cost efficiencies with less wastage of soap. Customize liquid volumes for any public or work area requirements with an easily adjustable interior dosage control mechanism.

Window / Level Indicator

Allows monitoring of lotion levels, at a glance.

New Locking System

Optional double lock and key system ensures that dispenser stays closed and vandal-free.

Easily Installed, Easily Loaded

Pre-fitted with strong self-adhesive backing so that the dispenser mounts easily and securely on most walls. Refills are designed for rapid re-loading.



Biomax[®]

INTERNATIONAL



SOAPS AND LOTIONS

PREMIUM QUALITY PRODUCTS

	Code	Product	Product Description	Packaging
Soaps and Lotions	MC10	ANTIMICROBIAL	Antiseptic Lotion Soap for restaurants, hospitals, schools & food plants.	12 x 800 ml
	MC25	SANITIZER	Waterless Hand Sanitizer ideal for field sites and portable toilets.	6 x 800 ml 12 x 800 ml
	MC30	CLASSIQUE GENTLE LOTION	Concentrated pH balanced Lotion Hand Soap for all environments.	12 x 800 ml
	MC35	GENTLE LOTION	Concentrated Lotion Hand Soap enriched with emollients to moisturize skin.	12 x 800 ml
	MC50	BODY AND HAIR	Concentrated all-purpose Body and Hair Lotion Soap.	12 x 800 ml
	MC70	PROTECTIVE	Rich Hand Cream and Skin Conditioner for use after hand-washing.	6 x 800 ml
	MC80	INDUSTRIAL	Citrus Fragrance Heavy Duty-Hand Cleaner for heavily soiled hands.	12 x 800 ml
Dispenser	AC50 SERIES	BIOMAXX INTERNATIONAL SOAP DISPENSER	93/16" Height x 43/4" Width x 33/4" Depth (23.5 cm x 12.0 cm x 9.4 cm)	12 per case

Biomax
INTERNATIONAL
SKIN CARE SYSTEM

by **Avmor**®

950 Michelin
Laval, Québec, Canada H7L 5C1

Tel.: 800 387-8074
Fax: 888 893-2849
e-mail: clientservice@avmor.com
www.avmor.com

Customized Services

Private Labelling

We have established a reputation for offering a wide variety of customized labels with our specialized private labelling service.

Colour Selection

The Biomax International Soap Dispenser is available in standard colours: Arctic White & Ice Blue, Black & Ice Blue and all Arctic White. Customized colours are available when certain minimum volumes are met.

Instructions / Installation (Biomaxx 24003)

On most wall surfaces, tape mounting is adequate. For porous, textured or wallpapered surfaces, screw mounting is recommended.

Sur la grande majorité des surfaces, le ruban adhésif est adéquat, par contre sur des surfaces texturées ou couvertes de papier peint, le montage avec des vis est recommandée.



Utiliser le tampon d'alcool inclus dans l'emballage pour nettoyer la surface du mur. Laisser sécher complètement.

Use the cleaning pad included in the bag to clean the mounting surface. Allow the surface to dry completely.

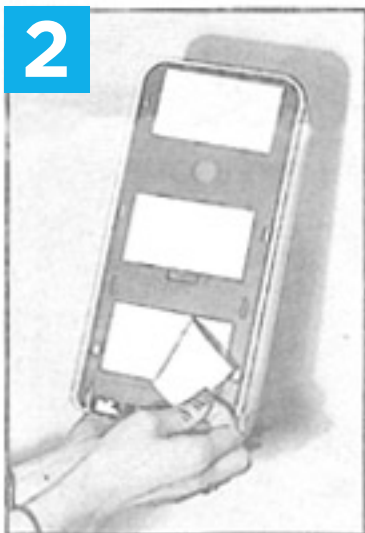

Enlever la pellicule protectrice du ruban adhésif installé sur l'arrière du distributeur.

Remove the protective paper from the self adhesive tape on the back of the dispenser.



Presser le distributeur contre le mur en s'assurant que les côtés soient à la verticale et bien alignés avec les tuiles.

Carefully align the dispenser on the wall surface. Please make sure that the sides of the dispenser align with the tile pattern.

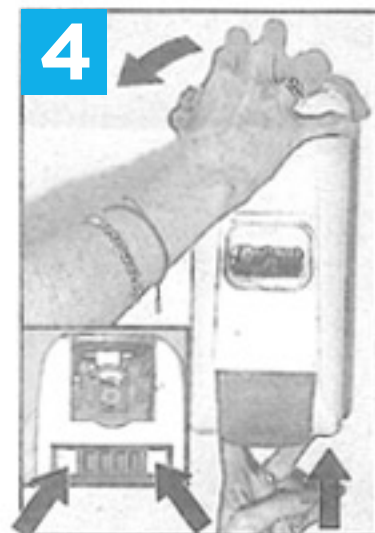

Pour ouvrir le distributeur, pousser sur le mécanisme de déverrouillage et rabattre le couvercle vers l'avant. S'assurer que la poignée est bien dans la position avancée.

To open the dispenser push the release latch up and pull the cover forward. Make sure that the handle is in the rest position.

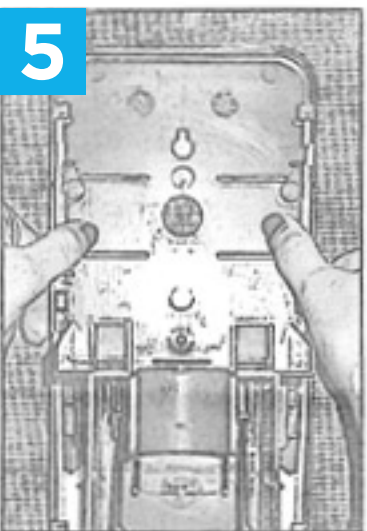

Appliquer de la pression directement sur les surfaces où sont les bandes adhésives. L'adhésion maximale ne sera atteinte qu'après 24 heures.

Use the cleaning pad included in the bag to clean the mounting surface. Allow the surface to dry completely.

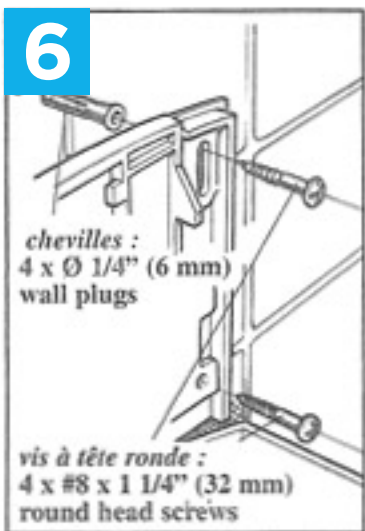

Pour une installation visée, marquer les trous à l'aide de la plaque de montage et percer le mur avec un foret de Ø 1/4" (6mm). Utiliser les 4 vis.

For screw mounting, mark the holes through the backplate. Drill 4 holes with a Ø 1/4" wall drill. Use all 4 screws.

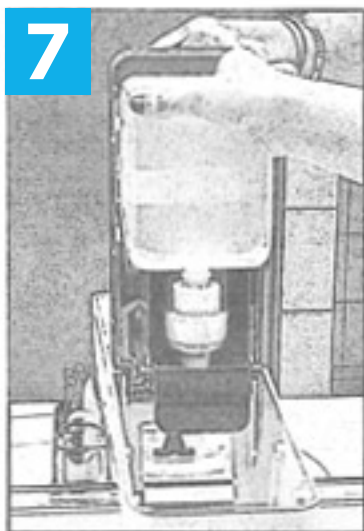

Placer la cartouche de savon sur son support et insérer l'embout de la pompe fermement dans son étrier. Refermer le couvercle.

Place the soap cartridge on the platform and insert the pump nozzle firmly in the guides. Close de dispenser.