

JohnnyVac



USER GUIDE
DONKEY - M1

Robot Mopping Cleaner

User Manual

Table of Contents:

1. Safety Instruction	3
1.1 Important notice	3
1.2 About the Instruction Manual.....	3
1.3 Suitable Usage	3
1.4 Attention Before Use	3
1.5 About Power supply and Battery	4
1.6 About Upgrade and Unauthorized modification	4
2. Components of Cleaner.....	4
2.1 Parts name.....	4
2.2 Specifications.....	6
3. Power Recharge	7
3.1 Recharge the main unit	7
3.2 Recharge the GPS navigator	7
4. Function Keys and Indicating Light.....	8
5. Cleaning Modes.....	9
5.1 Fast clean	9
5.2 Deep clean	9
6. Cleaning Operation.....	10
7. GPS navigator.....	11
7.1 Build up connection between GPS	11
NAVIGATOR AND MAIN UNIT	
7.2 How to use one GPS navigator	12
7.3 How to use multiple GPS navigator.....	12
8. Operation Guide	13
8.1 White Color Cloth Installation.....	13
8.2 Blue Color Cloth Installation	13
8.3 Usage of Deep Clean Mopping Pad	14
8.4 Set up GPS navigator.....	15
8.5 Enable Cleaning Function	16
9. Maintenance	17
9.1 How to Clean and store the Mopping Cleaner.....	17
9.2 How to maintain the Wheels	18
9.3 How to clean the Mopping Pad.....	18
10. Troubleshooting	18

1 Safety Instruction

1.1 Important notice

Please do not tear apart the mopping cleaner, including main unit, adapter, GPS navigator randomly. If damaged, please contact professional maintenance team.

The product is mainly for indoor use on Floor, not applicable for outdoor.

1.2 About the Instruction Manual

Read the instruction carefully;

Take caution for nonstandard operation that are not mentioned in this manual.

Otherwise, it may lead to damage of the robot or harm on people.

1.3 Suitable Usage

Donkey Robot Mopping Cleaner is applicable for hard floor, including wood floor, plastic floor, laminate floor, Tilt, Linoleum Floor, Plastic leather floor etc. It's ideal for smooth-faced hard floor;

The cleaning result can be affected on non-smooth floor.

The mopping cleaner is used under room temperature environment.

Please do not use under extremely hot or extremely cold environment.

When the temperature is under 0, the mopping cleaner stops working.

1.4 Attention Before Use

The appliance is not for persons (including children) with reduced physical sensory or mental abilities, or lack of experience and knowledge, unless they have been given supervision of instruction concerning use of the appliance by a person responsible for their safety.

Please do not use the mopping cleaner to clean large tracts of debris, pigments or chemical substances.

Please keep the robot away from burning or smoky things.

Please do not use the robot in dangerous environment such as gas station or chemical plant etc.

Before use, please keep away the easily overturned objects. And remove the power cables or curtain cables.

Before use, please use a paddle to prevent the robot going into open balcony.

When cleaning the robot, please use dry cloth. Don't use water to spray or flush. And avoid putting the robot inside water, in case it's short-circuited.

1.5 About Power supply and Battery

Please use the standard power supply to charge the robot. The standard socket should be 100-240V

If the power cable or plug is damaged, please replace a new one in time.

- Please keep the power adapter away from over-hot or sharp objects.
- Please avoid using wet hands to operate or charge the robot.
- Please use clean cotton cloth to clean the robot.

1.6 About Upgrade and Unauthorized modification

The robot upgrade should be done by manufacturer. Any unauthorized modification can lead to the robot damage. Users possibly can not enjoy the warranty.

2. Components of Cleaner

2.1 Parts name

- Function key
- Sensor of GPS navigator
- Indicator light for GPS navigation system
- Buffer strip
- Mopping Pad
- Anti-drop off sensor
- Charging Port
- Direction
- Wheel Handle



GPS Navigator

- GPS Navigator
- GPS Navigator Indicator
- GPS Navigator power charge port
- GPS Navigator on/off Switch



Power adapter



Dry Mopping Pad

- Fixed place for dry mopping cloth
- Passage for anti-drop off sensor

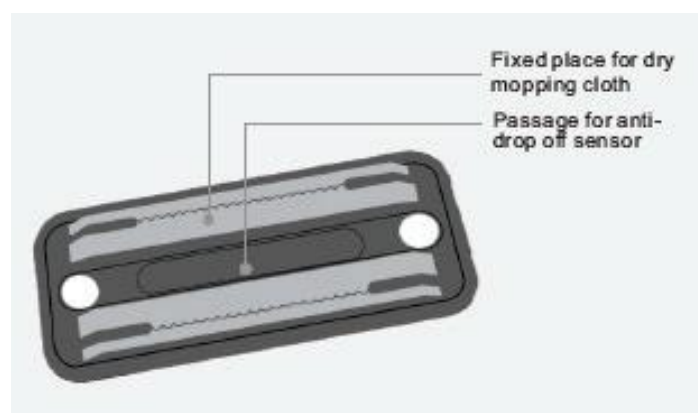

Wet Mopping Pad

- Water inlet cover - Water tank - Fixed place for wet mopping cloth - Water outlet cap



2.2 Specifications

Basic Specification

Voltage	7.2V
Max Power	3.6W
Charge Time Main Unit	2h
GPS Navigator	4h
Working time after fully recharged	
Fast Clean.....	4h
Deep Clean.....	2.5h
Size.....	210.5 x 246 x 79MM
Net Weight.....	1.85kg

Power Rated

Recharge Voltage.....	100V-240V
Output Voltage	12V
Rated frequency.....	50Hz
Output Current	1A

3. Power Recharge

3.1 Power Recharge for Main Unit

Please find the power charge port in bottom of the robot. Connect one side into the power charge port, the other side into the standard power socket. Please power on the robot until the power indicator shows blue light constantly.

Note: Do not power on the robot with any mopping pads. If you want to use the robot, please cut off the power adapter.

The power charging time is slightly different upon working temperature, floor materials etc. When the temperature is lower than 0°, the robot can not recharge.

Power Charge Port

3.1 Power Recharge for Main Unit

Please find the power charge port in bottom of the robot.

Connect one side into the power charge port, the other side into the standard power socket.

Please power on the robot until the power indicator shows blue light constantly.

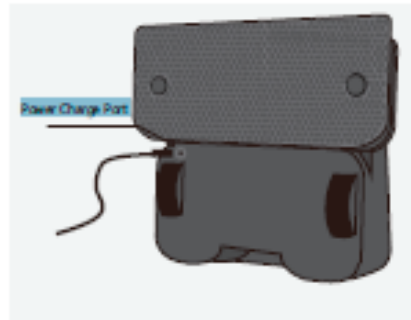

Note:

Do not power on the robot with any mopping pads. If you want to use the robot, please cut off the power adapter.

The power charging time is slightly different upon working temperature, floor materials etc. When the temperature is lower than 0°C, the robot can not recharge.

3.2 Power recharge for GPS Navigator

For 1st use, please adjust the switch in bottom of GPS navigator from "0" to "1". If not use for long time, please adjust the switch to "0"

- Charge the Navigator by USB cable:
- Connecting the charging port (in bottom of navigator) in one side and connecting the power by USB port in another side.
- Please charge the navigator until the GPS indicator gives out green light constantly.

3.2 Power recharge for GPS Navigator

For 1st use, please adjust the switch in bottom of GPS navigator from "0" to "1". If not use for long time, please adjust the switch to "0"

Charge the Navigator by USB cable:
Connecting the charging port (in bottom of navigator) in one side and connecting the power by USB port in another side.
Please charge the navigator until the GPS indicator gives out green light constantly.

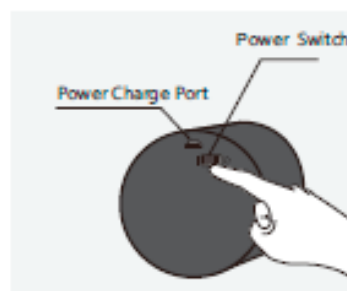

4. Function Keys and Indicating Light

Fast Clean Button

Fast clean adopts dry mopping pad matched with white mopping cloth; or can adopt wet mopping pad matched with blue mopping cloth.

Press the fast clean button, fast clean starts.

Press again to stop the function.

Constant blue light, entering into the fast cleaning mode

Flashing blue light, the fast cleaning mode is stopped

Deep Clean Button

Deep Clean only adopts wet mopping pad matched with blue mopping cloth.

Press the deep clean button, deep clean starts.

Press again to stop the function.

Power Button

Press Power button to start the robot.

Press again for 2 seconds to stop the robot

Constant blue light: the robot starts

Constant Red light or flashing red light: Lacking of power

GPS Navigation System Indicator

Connection Status

Constant blue light: GPS Navigator enters into stable working status

Flashing Blue Light GPS Navigator is building up connection with the robot

Other Status

Regular flashing blue light: in thinking status

Irregular flashing blue light in sleeping status

Note: You can know the signal by GPS navigator indicator. Totally 3 bright lights means signal is strong. If indicator light is not bright, it means the connection between the robot and GPS navigator is failed.

GPS Navigator Indicator

Flashing blue light: signal is in transmission

Constant blue light the GPS: Constant blue light navigator has already built up connection with the robot.

Constant red light: The GPS navigator is lacking power.

5. Cleaning Modes

5.1 Fast Clean

a. Introduction

Fast clean adopts fast cleaning mopping pad matched with white mopping cloth; Please keep the white cloth dry.

Or can adopt deep cleaning mopping pad (with water tank) matched with blue mopping cloth. Please keep the blue cloth wet.

Fast cleaning modes

1. Fast cleaning mopping pad matched with white mopping cloth
2. Wet mopping pad (with water tank) matched with blue mopping cloth

b. Cleaning Routes

Under fast cleaning modes, the robot will clean in “Zigzag” way



b.Cleaning Routes

Under fast cleaning modes, the robot will clean in “Zigzag” Way :



5.2 Deep Cleaning Mode

a. Introduction

Deep Clean only adopts deep clean mopping pad matched with blue mopping cloth.

Deep Cleaning Mode

Deep clean mopping pad (with water tank) matched with blue mopping cloth

b. Cleaning route

Under deep cleaning mode, the robot will move forward towards left, then go backwards a bit, and move forward towards right. The robot keeps moving in this way.

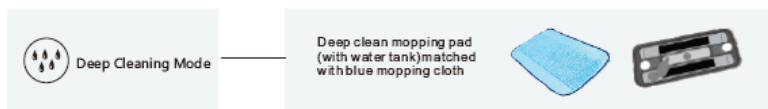

b. Cleaning route

Under deep cleaning mode, the robot will move forward towards left, then go backwards a bit, and move forward towards right. The robot keep moving in this way.

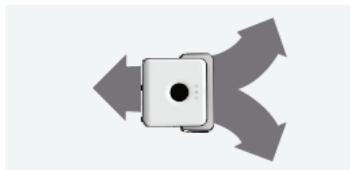

Note: Please do not use the mopping robot on carpet.

The mopping cloth is reusable

Fast clean mopping pad matched with white mopping cloth; Please keep the white cloth dry. Deep cleaning mopping pad (with water tank) matched with blue mopping cloth. Please keep the blue cloth wet.

6. Cleaning Operation

Cleaning Sequence

Donkey Robot divide the cleaning area automatically. First it cleans the right area, then cleans the left area. After cleaning the open area, **Donkey** robot will clean around the wall or furniture. After finishing one area, it goes to next area. After finishing the task, **Donkey** robot will go back to the starting point.

Donkey robot clean the open area in a planned cleaning route. When meeting with furniture or other objects, it will clean around them, and turn to next area. **Donkey** robot can detect the fall automatically. So when it comes to stairs, it will turn back to the cleaning area.

Note: For the platform of the gap of 60cm, it's better to put obstacles to ensure safety.

Donkey mopping robot can detect carpet and go pass the carpet for clean.

Note: If the carpet has a similar height with hard floor, it's necessary to set temporal obstacles, to enable the edge detection of **Donkey** robot.

After cleaning the open area, **Donkey** robot will clean against the wall or other edges.



Stop/Continue

Donkey will stop cleaning if it's lift up or it's function keys are pressed. When **Donkey** is paused to work, the function keys of "**Deep Clean**" or "**Fast Clean**" will give out flashing blue light. Meanwhile, **Donkey** has saved the map of cleaned area.

If you want to continue cleaning, please put **Donkey** within 2 meters away from the GPS navigator. Then place **Donkey** back in the same starting point. Press again the flashing function key.

Donkey will continue to clean the non-cleaned area after confirming the location in the map.

Donkey can both clean the cleaned area and non-cleaned area. If you want **Donkey** to clean in suspended location, it's required more time to confirm its location. And the preparation time is related with the distance between **Donkey** and GPS navigator.

If you want to stop cleaning, keep pressing the power key for 2 seconds. **Donkey** will be turned down.

7. GPS Navigator

7.1 Build up connection between GPS Navigator and Main Unit

When **Donkey** robot is trying to build up the connection, one of the indication light on the robot will give out flashing blue light. After it's connected, all the 3 indication lights will give out constant blue light.

If the robot is removed outside the scope of GPS navigator, all the 3 indication lights on the robot will go out.

To confirm the location of GPS navigator, the robot will move forwards it sometimes. After confirming, it continue to clean.

If the cleaning work is paused, the robot will save its cleaning map. After finish the whole room, the robot will build up a new map.



Clean without GPS Navigator

Donkey mopping robot can work without GPS navigator/ But the cleaning area will be reduced. And it can not clean effectively the edges of each area.

7.2 How to use one GPS navigator

Please place the GPS navigator in the middle of the room. And start the robot near GPS navigator. The robot starts to clean the area according to the cleaning mode and signal given by the GPS navigator.

If you have many rooms, to ensure the cleaning coverage, please put GPS navigator in larger room. After finishing the cleaning work, you can move the GPS navigator to clean other areas.

7.3 How to use multiple GPS navigator

To increase the cleaning coverage of **Donkey** robot, you can use multiple GPS navigators (Need to buy extra) The location of other GPS navigator should be adjoining, with distance between 6-7 meters, to avoid overlap region.

Donkey robot can automatically build up connection from one GPS navigator to another.

GPS navigator has programmed the signal tracks, and adopt their color to divide.

Please see more details in GPS navigator. Only different GPS navigators with different colors can use synchronously

To increase the cleaning coverage of Donkey robot, you can use multiple GPS navigators (Need to buy extra) The location of other GPS navigator should be adjoining, with distance between 6-7 meters, to avoid overlap region. Donkey robot can automatically build up connection from one GPS navigator to another.



one GPS navigator

GPS navigator has programmed the signal tracks, and adopt their color to divide. Please see more details in GPS navigator. Only different GPS navigators with different colors can use synchronously.



More GPS navigators

8. Operation Guide

8.1 White Color Cloth Installation

Operation Steps

1. Please get down the dry mopping pad.
2. Pave the white color mopping cloth and put the dry mopping pad on. Stuck the edges of white color cloth into the mopping pad. Don't conceal the middle passage of mopping pad.
3. Install the dry mopping pad back to the robot. The magnet device can help them fixed well.

Photo Reference

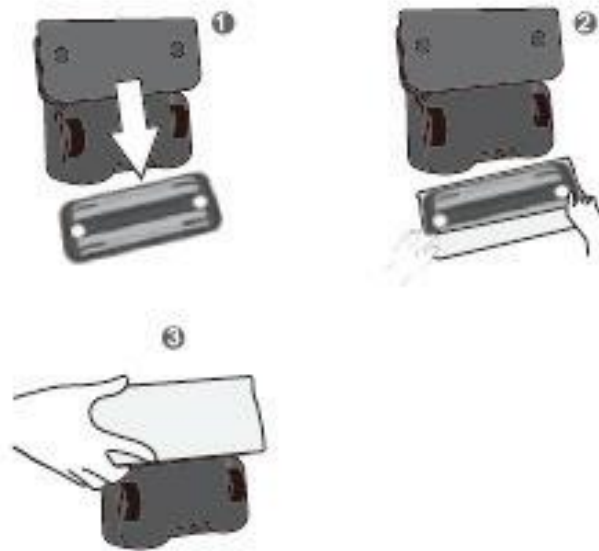

8.2 Blue Color Cloth Installation

Operation Steps

1. Put down the deep clean mopping pad.
2. Fill the water into the water tank. You can add a little white vinegar or soda. Then tight the water tank (Please do not add washing power or cleaner, to avoid skidding out of control).
3. Pave the blue color mopping cloth and put the deep clean mopping pad on. Stuck the edges of blue color cloth on the mopping pad. Don't conceal the passage of mopping pad in the middle.
4. Install the deep clean mopping pad back to the robot. The magnet device can help them fixed well.

Photo Reference

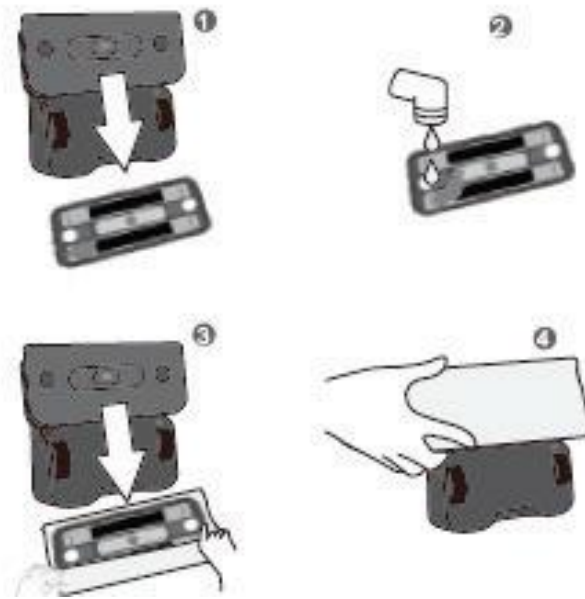

8.3 Usage of Deep Cleaning Mopping Pad

Under fast or deep cleaning modes, the deep cleaning mopping pad exudes water, to enable the blue color mopping cloth wet.

- Add water into the water tank

Operation Steps

- Please open the water inlet cover and fill water in. Please tight the cover to avoid water seepage.
- The deep clean mopping pad is used with blue color mopping cloth. Don't use with white color mopping cloth.

Photo Reference

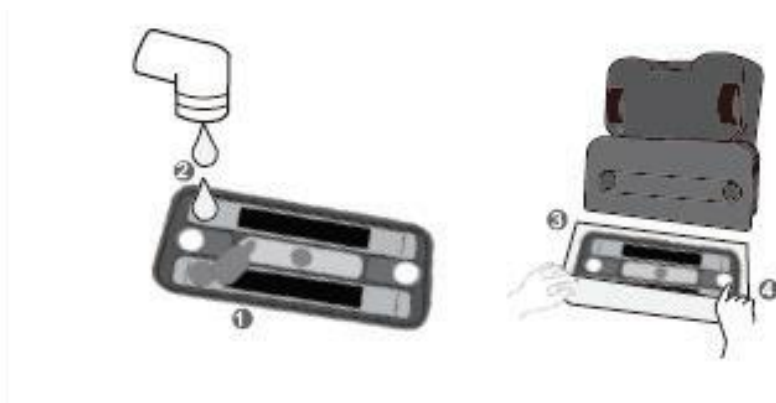

Note: The exudation rate of liquid is dependent on the liquid and floor materials. When first starting deep clean mode, please do not make the cloth too wet. You can increase humidity according to your demands.

When operating deep clean mode, please ensure someone is here. After the robot finishing the work, please lift off the deep clean mopping pad. In case the mopping pad keeps exuding too much water on the floor.

AFTER FINISHING DEEP CLEAN,

- Please pour out the rest liquid
- Keep the inlet cover opened. After the water tank is dry, you can install the mopping pad back to robot again.

8.4 Set up GPS navigator Operation Steps

1. For 1st use, please turn on the switch in the bottom of navigator to “1”; If not use any more, please turn the switch to “0”
2. Please press the “GPS” button until blue light flashes . Put the navigator to horizontal position (on desk/table);
3. Please choose the ceiling without barriers. The navigator is better to be put in middle of the room.

Photo Reference

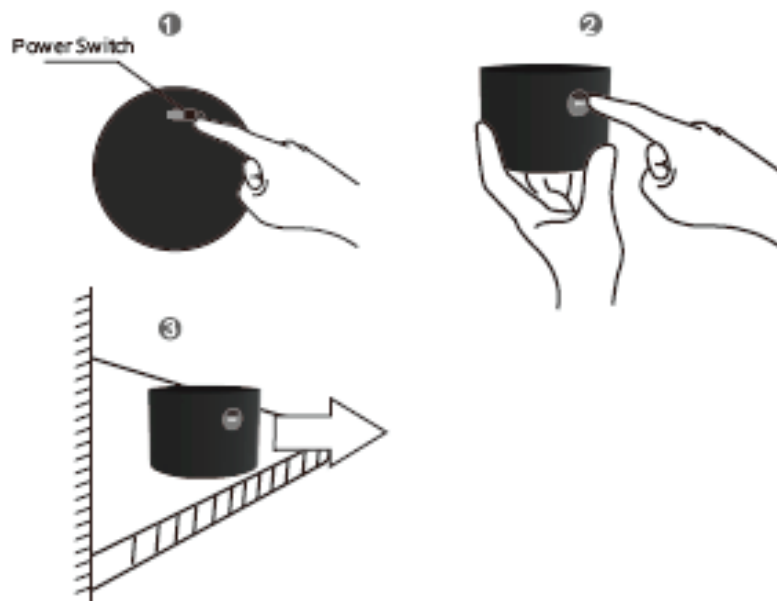

How to improve the performance of GPS navigator?

GPS navigator instructs the robot by signal refraction from the ceiling. So please put the robot in open ceiling without barriers.

Please do not move the GPS navigator when the robot is working.

Please do not put the GPS navigator on the floor in case the robot crashes towards it.

8.5 Enable Cleaning Function

Please put the robot on the floor. And keep the distance of 2 M - 2.5 M, by faced with GSP navigator.

Power

Press the power key, and the power button gives out constant blue light

Fast Clean

If wanna adopt fast clean mode, please press "Fast Clean" button

Deep Clean

If wanna adopt deep clean mode, please press "Deep Clean" button

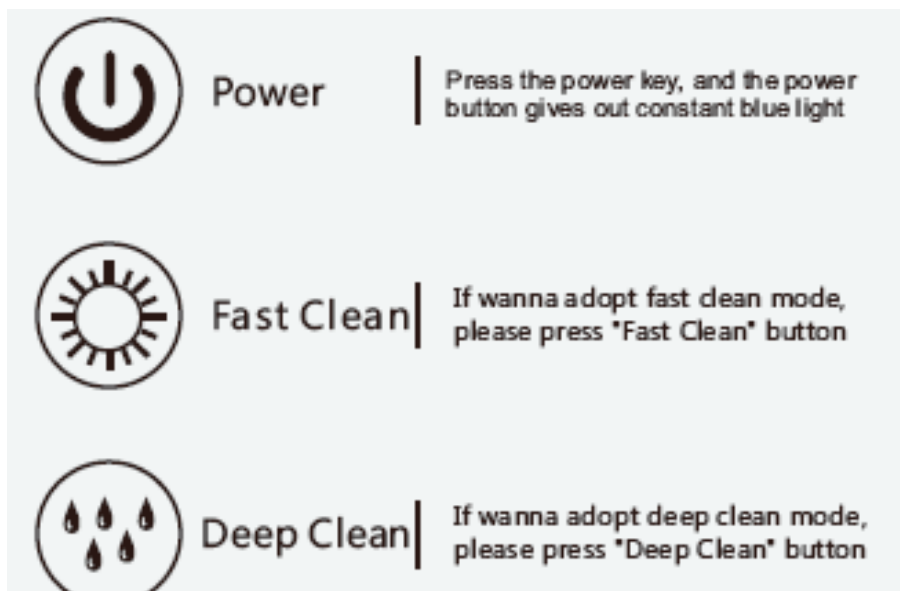

When **Donkey** mopping robot detects the signal of GPS navigator, one of the GPS system indication light will give out flashing blue light. After building up connection, the indication light will give out constant blue light. After cleaning the appointed area, **Donkey** robot will come back to the starting point. If power is not enough, the robot will come back to starting point as well.

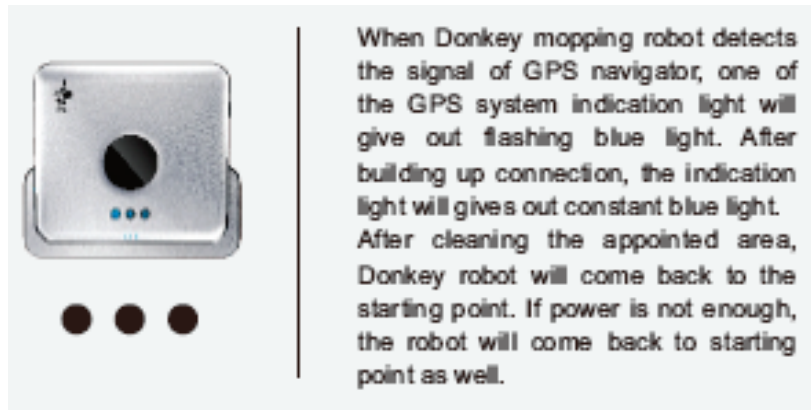

Keep pressing the power button for 2 seconds, you can turn down **Donkey** mopping robot.



Press the GPS navigator switch key, you can turn down the GPS navigator. The indication light of the GPS navigator will also put off.

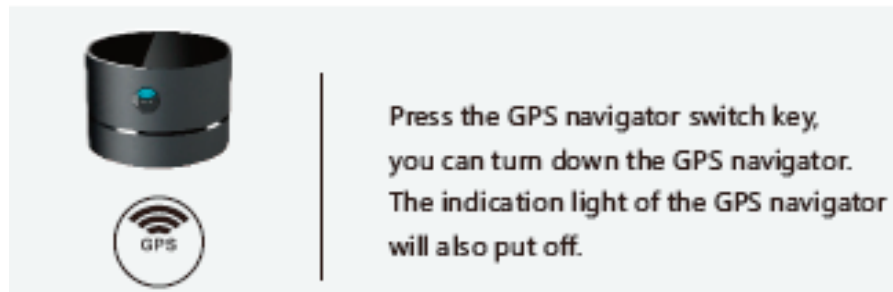

9. Maintenance

9.1 The Clean and Storage of **Donkey** Mopping Robot

BEFORE CLEANING THE ROBOT, PLEASE CUT OFF THE POWER:

- Please use dry cloth to clean the main unit. Do not use water or put the robot into water.
- Please use dry cloth to clean the wheels. Cut off power before clean and wring out the wet cloth.

When power on or store **Donkey** mopping robot, please place vertically with handles downwards.

9.2 The Maintenance of Wheels

After used, the wheels of the robot can be stucked with scraps of paper.It can affect the performance of robot. Please check and clean regularly.If it's difficult to clean slots of the wheels, please use Pliers or scissors

9.3 The Maintenance of Deep Clean Mopping Pad

You can put the Deep clean Mopping Pad into water for clean. Please do not use dishwasher or soap for clean. Before installing the mopping pad, please dry it.

Please do not remove the inlet cover when the robot cleans the floor.

If the inlet cover is damaged or dirty, please replace yourself.

10. Troubleshooting

GPS Navigation System Indicator -If **Donkey** mopping robot has problems during clean, the system indicator lights on the robot will have the following circumstances:

Common Troubles	Possible reasons	Solutions
a. The 2nd indication light gives out constant red light	Failure in robot system	<ul style="list-style-type: none">• Keep pressing the power button,turn down the robot.• Turn the wheels for 15 seconds.• Install the dry mopping cloth. And restart the robot on the floor.• If the red light is put off, press the fast clean button.• If still having red light, please contact local service.
b. The 2nd indication light gives out red light for 2-6 times.	Donkey Robot is stuck	Put Donkey robot to new areas and restart.
c. The 2nd indication light gives out red light for 14 times.	The motor of Donkey robot is overheated	Press the power button and turn down Donkey robot. Restart again after it's cooled down.
d. The 2nd indication light gives out red light for 15 times.	Donkey robot is stuck in small range	Put Donkey robot to new areas and restart.
e. When pressing fast clean button or deep clean button, the The 2 nd indication light gives out red light, and Donkey robot beeps 3 times.	The anti-collision sensor is in activated status. Donkey robot can not move ahead.	Please get down the mopping cloth and install again. Important notice: The mopping cloth should not conceal the middle passage of the mopping pad. The mopping cloth should be placed well, to avoid the mopping cloth can not fit the robot.

If Donkey mopping robot has troubles when being recharged,

The system indication light can have the following circumstances:

Common Troubles	Possible reasons	Solutions
f. The 2nd Indication light gives out constant red light	Failure in robot system	This trouble is not a recharging problem. The solution can be checked from trouble a.
g. The 2nd indication light gives out red light for 7-8 times	Failure in power recharging	Please contact local service
h. Indication lights and Power button are both flashing, and the robot keeps beeping	Power adapter is not matched with the robot	Please replace Donkey standard power adapter.

The common troubles and solutions for Deep Clean Mopping Pad

Common Troubles	Possible reasons	Solutions
i. Water seepage	Inlet cover or outlet cover is not tight well	Please check and inlet cover or outlet cover carefully, and ensure good sealing.
j. No water is out from the outlet cover	Troubles in outlet cover	Please replace a new outlet cover.

The Common Troubles and Solutions for GPS Navigator

Common Troubles	Possible reasons	Solutions
k. Donkey mopping robot can not connect with GPS Navigator	The location between Donkey robot and GPS navigator is not appropriate	<p>Please press the on/off switch of GPS Navigator and place it in high position. The blue light should be faced with open area.</p> <p>Press the robot power button, and place it 2-2.5 meters away from GPS navigator. The robot should be faced with GPS navigator.</p> <p>Install the mopping cloth, and press fast clean button. The robot will move towards the GPS navigator. Normally within 30 seconds, the robot can be connected with GPS navigator.</p> <p>When the indication light turns from blue flashing light to constant blue light, the robot has built up connection with GPS navigator.</p> <p>If the robot can not move forwards, please check common troubles from a. - h.</p>

Common Troubles	Possible reasons	Solutions
l. The Indication light of GPS navigator gives out flashing red light	The GPS navigator is lacking power	Please recharge the GPS navigator.
m. During the clean period of Donkey mopping robot, the GPS navigator is turned off.	The signal of GPS navigator is affected	Please keep the GPS navigator away from Plasma or LCD TV. Don't put the GPS navigator within 1.5 meters from TV. Also keep the GPS navigator away from the room of fluorescent lamp.
	The robot move out of the navigation range	It's a normal situation. When the mopping robot return back to the navigation range, the GPS navigator will restart again.
n. Adopts multiple GPS navigators, but Donkey mopping robot can only build up connection with one GPS Navigator.	The setting of adjoining GPS navigator	Please adjust the distance of GPS navigator to be 4.5 meters. After later clean work, you can gradually increase the distance. When Donkey mopping robot is working, please do not remove the GPS navigator.

Other Common Troubles and Solutions

Common Troubles	Possible reasons	Solutions
p. Donkey mopping robot can only work in small range	Do not use GPS navigator	<ul style="list-style-type: none"> • Check the GPS navigator and ensure it's turned on. Also check whether there are interference • Whether there are cupboard or ceiling fan on the ceiling • Whether the ceiling is too high or uneven.
	The cleaning cloth is not installed well	Get down the cleaning cloth and install again. Please follow the rules: <ul style="list-style-type: none"> • Please avoid concealing the middle passage of the cleaning pad. • Ensure the cleaning cloth is fixed well with the mopping pad.
	The wheels or tread has troubles	Please check the wheels and ensure it's clean. Please check the tread and ensure the tread is well fixed with the wheels. If the tread is loose, please contact the local agent.
	The wheels skid	Please use hot water to make the cloth wet. Then clean the wheels and dry them. After that, try to work again.

	The cleaning cloth is not installed well	Please get down the cloth and install again. Please follow the rules: <ul style="list-style-type: none"> • Please avoid concealing the middle passage of the cleaning pad. • Ensure the cleaning cloth is fixed well with the mopping pad.
	The wheels or tread has troubles	Please check the wheels and ensure it's clean. Please check the tread and ensure the tread is well fixed with the wheels. If the tread is loose, please contact the local agent.

Common Troubles	Possible reasons	Solutions
r. The Donkey robot goes backwards	The anti-drop off sensor is in activated status	<ul style="list-style-type: none"> • Please get down the cloth and install again. Please follow the rules: <ul style="list-style-type: none"> • Please avoid concealing the middle passage of the cleaning pad. • Ensure the cleaning cloth is fixed well with the mopping pad. • Uneven floor or too wide Grouting line can make the robot goes backwards. Please put the robot on smooth surface.
s. The robot begin to move, but do not enter into the cleaning modes	The robot is in stand-by mode	Please press the power button again
t. Press the power button to enable the robot to clean the rest area, but Donkey is only repeatedly cleaning the same area	when Donkey continues to clean	<ul style="list-style-type: none"> • It's normal that Donkey can repeatedly clean the same area when it tries to local itself. • If you want to make a fast location, you can restart the Donkey robot with GPS navigator nearby. The direction and location is same as previous • If Donkey can not locate successfully, it will re-adjust the clean work.
u. Donkey robot can not recharge	The power adapter is not matched	Please use Donkey standard power adapter. If still having problem, please contact local agent
	The battery power should be adjusted	Please use Donkey standard power adapter to charge the robot for 12 hours. And operate the cleaning modes until the power is ran out. Repeat the following operation for 3 times. The robot battery will be adjusted.

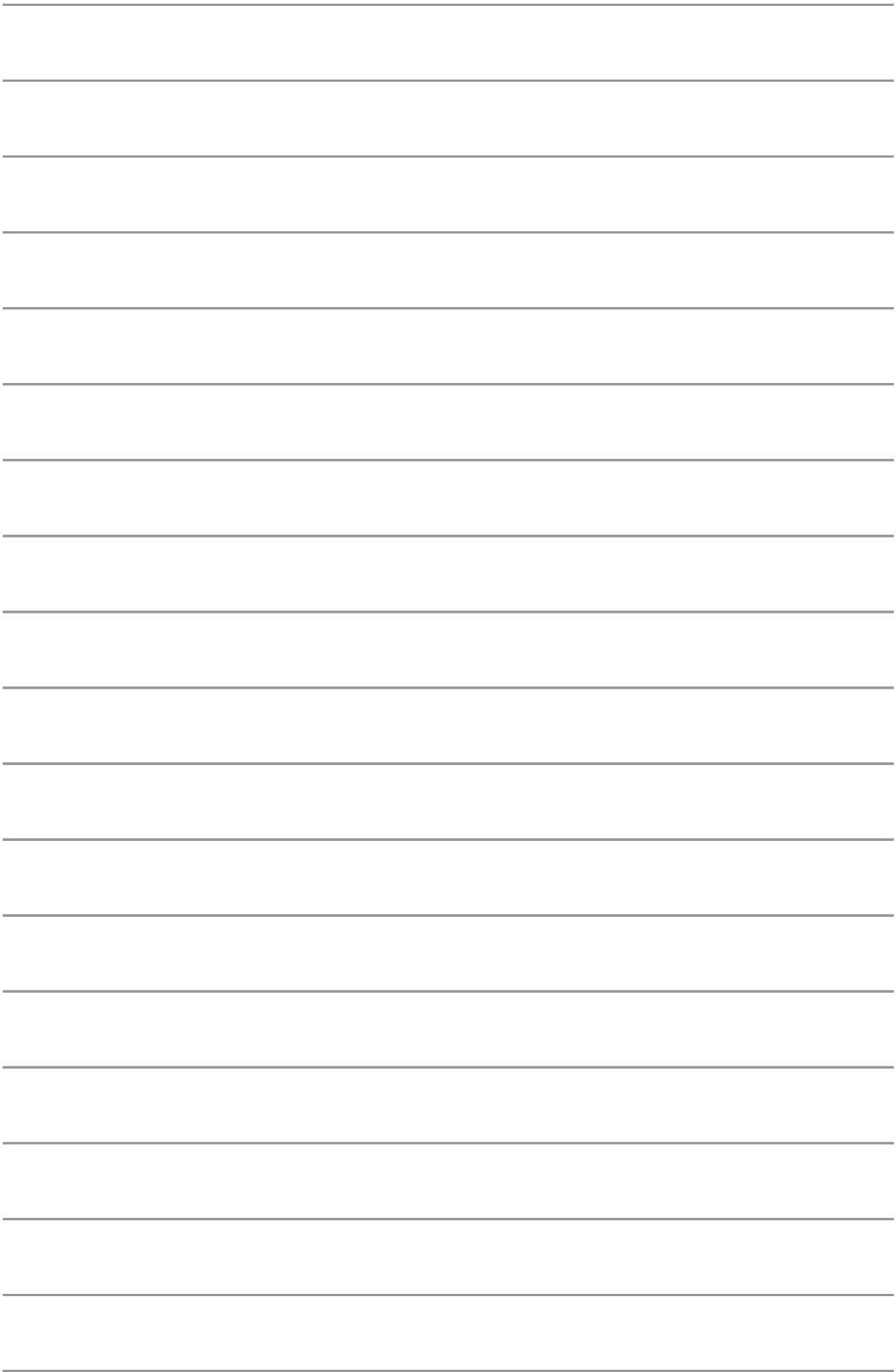

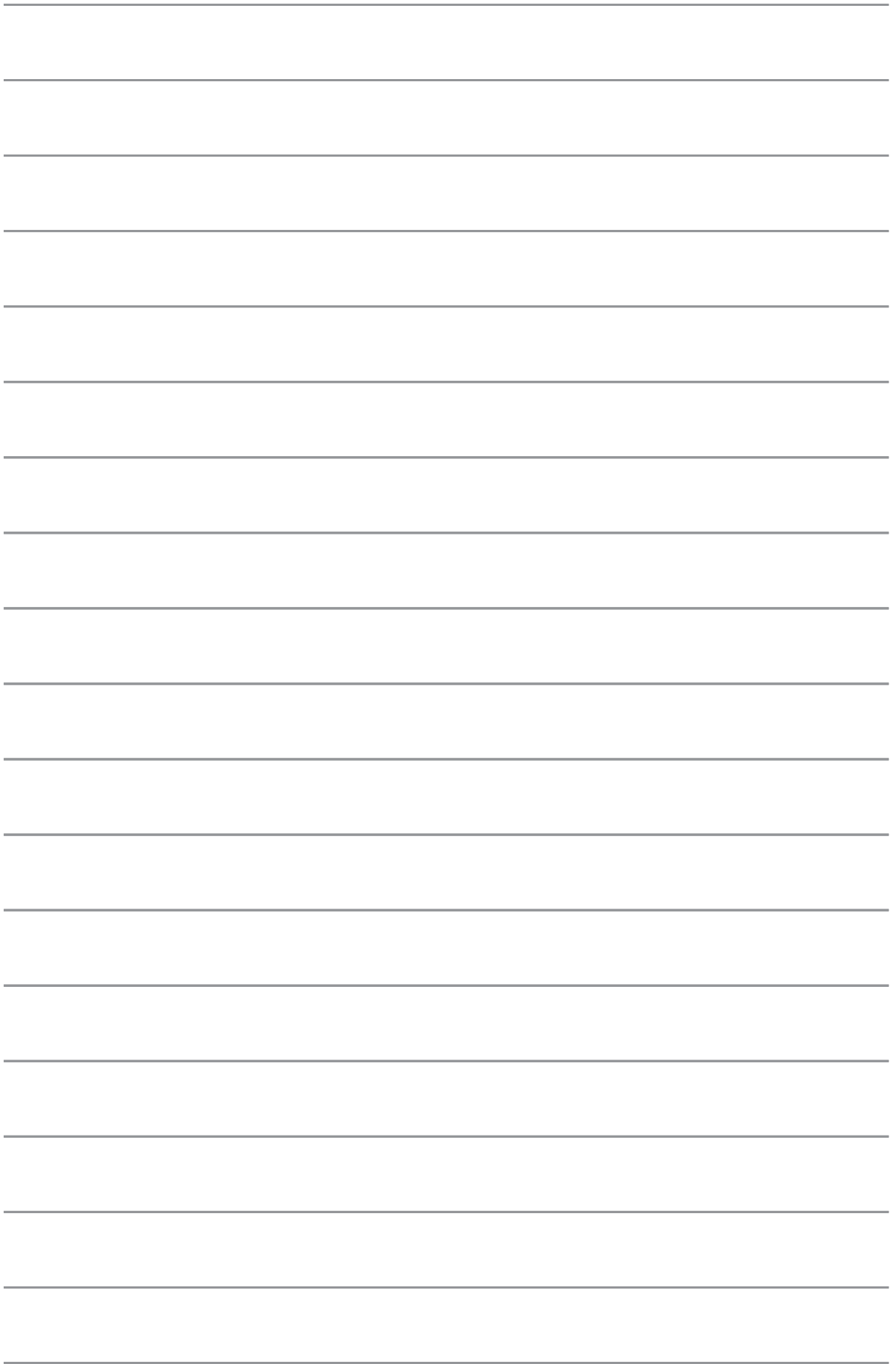

***Residential and commercial
vacuum cleaner specialist***



FOR
PARTS, ACCESSORIES & VACUUM BAGS

VISIT OUR WEBSITE AT
WWW.JOHNNYVAC.COM