

# HOW TO CLEAN WITH OMNICLEAN

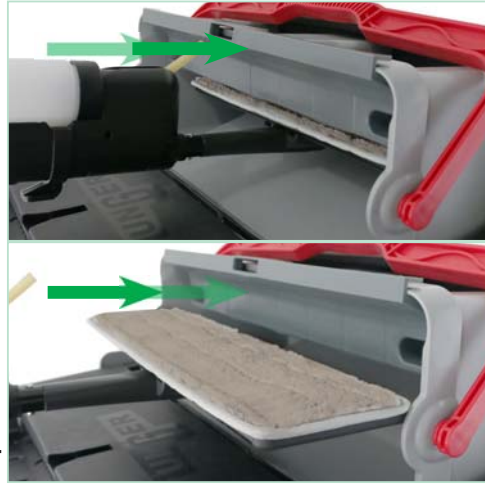

Quality Tools for Smart Cleaning™

Step 5



When mop pad is dirty, insert into scrub board bucket and scrub debris off pad.

Step 6

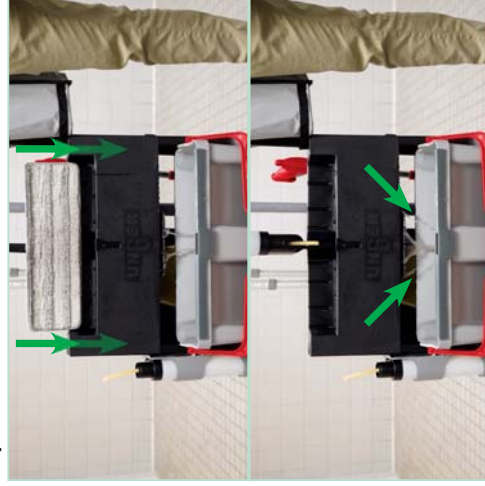

Insert mop into wringer, wring mop 2x making sure to completely pull mop out of wringer each time.

Step 7

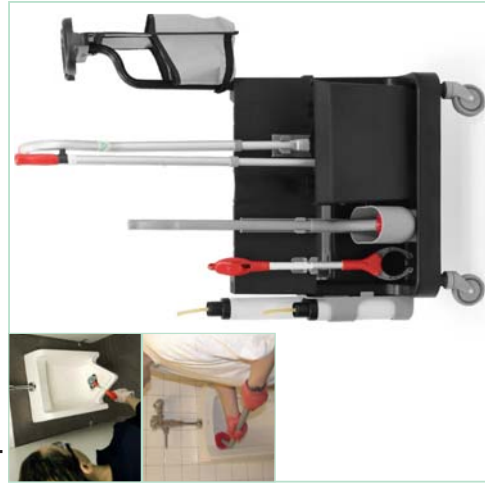

Use restroom accessories as needed.

Step 8

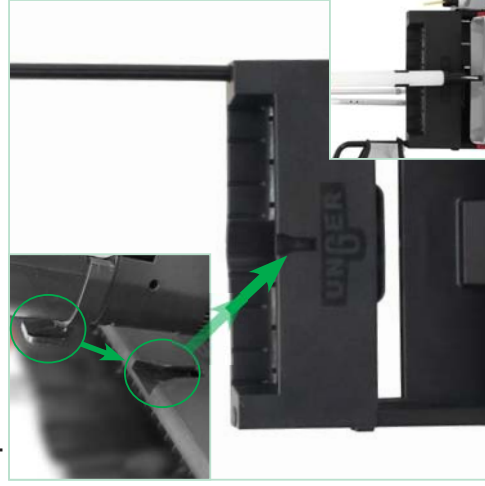

When mopping is complete, empty rinse bucket into utility sink and hang Excella into storage clip.



## Unger OmniClean Restroom Kit

REF NO: CLRRK CASE NO: 1

- Offset Pole with Actuator
- Small Bottle 0.5L
- Large Bottle 1L
- Pad Holder
- Microfiber Pads (2)
- DustPan Telescopic red
- Toilet Brush Telescopic red
- Toilet Brush Handle w/2 brush heads
- NiftyNabber Red 18"
- SmartColor Rectangular Labels (2)
- Carriage with Wringer
- Gray Bucket
- Gray Scrub Board
- Offset Tube Carriage Handle
- Red Bucket Handle
- Dual Bottle Holder Clip
- DustPan Holder Clip
- Toilet Brush Holder Clip
- NiftyNabber Holder Clip
- Storage Caddy
- Excella Clip
- Casters (4)



View our OmniClean Video Here

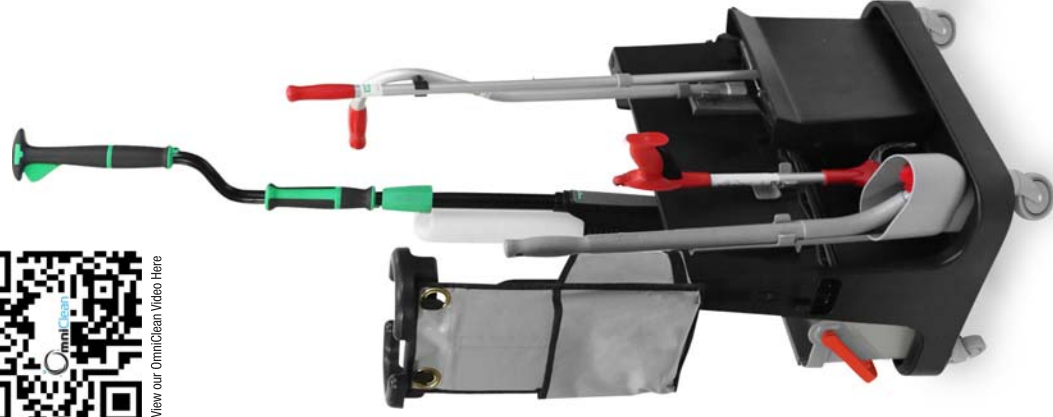

# ASSEMBLY

**Caster Installation**



Push casters firmly into the base of the carriage.

**Handle Installation**

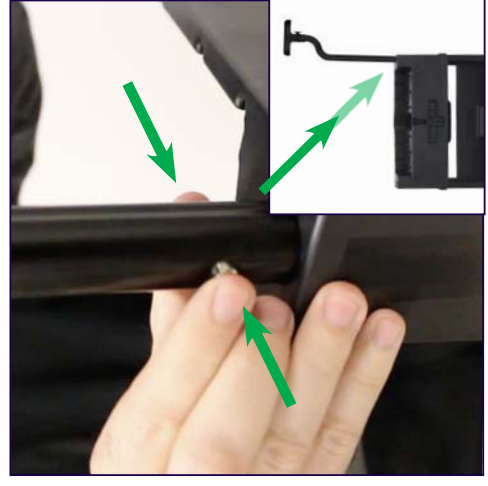

On the handle, press metal pins and guide into the carriage base until you hear a click.

**Mop Head Installation**



Press metal pins on mop pad holder into the base of the Excella pole until you hear a click.

**Accessory Installation**

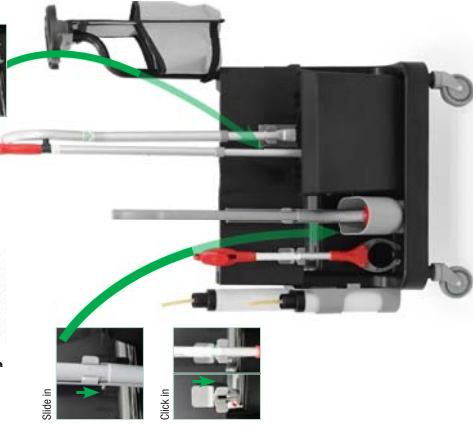

Attach accessory clips and store tools; place dustpan as pictured.

# HOW TO CLEAN WITH OMNICLEAN

**Step 1**



Fill scrub board bucket with water to the fill line and place bucket on carriage. *(Scrub board bucket is always on Unger logo side)*

**Step 2**



Adjust the height of Excella pole to chin height; tighten the locking collar.

**Step 4**

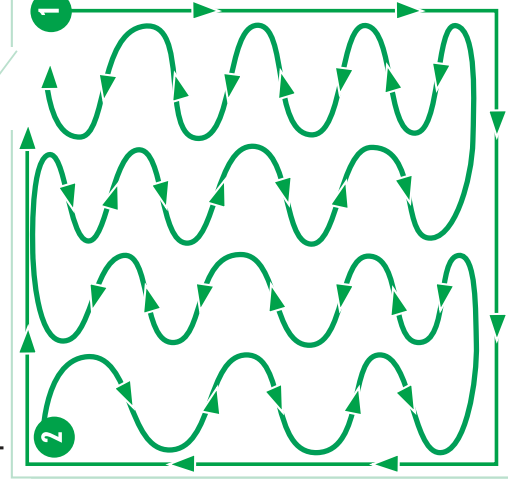

Mop with "S" motion.

**Step 3**

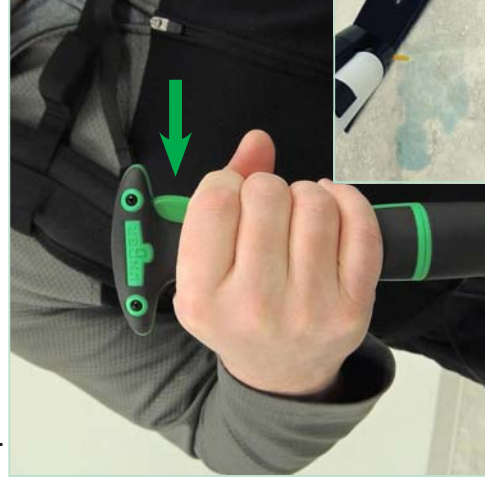

Dispense cleaning agent.



Quality Tools for Smart Cleaning™

# Never Clean with Dirty Water Again



Patented Stand-Up  
Wringer

Soil-Catching  
Bucket

StayClean Bucket

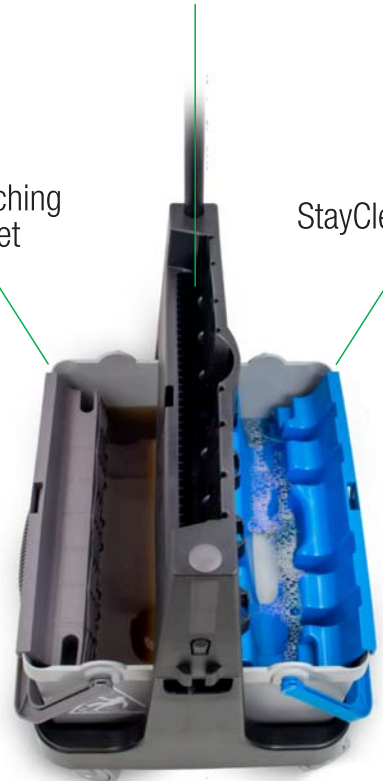

OmniClean features dual bucket technology to separate clean and dirty water, ensuring the StayClean bucket is always clean.

21812 01/2021



CATALOG DESCRIPTIONS/SPECIFICATIONS





Unger OmniClean is the newest, groundbreaking innovation in floor care. OmniClean features dual bucket technology to separate clean and dirty water, ensuring the StayClean bucket is always clean. With advanced design features, the powerful scrub board removes dirt, grime and germs from the microfiber mop pad. The horizontal wringer removes remaining debris leaving a clean mop pad! You'll never clean with dirty water again.  
**Start truly cleaning with OmniClean today!**



### Unger OmniClean Dual Bucket Kit

PART NO.: **CLBK1** CASE QTY.: **1**

- Straight Pole with Clip
- Pad Holder
- Microfiber Pads (2)
- SmartColor Rectangular Labels (2)
- Carriage with Wringer
- Gray Bucket (2)
- Blue StayClean Guide
- Gray Scrub Board
- Gray Bucket Handle
- Blue StayClean Bucket Handle
- Straight Carriage Handle
- Casters (4)



### Unger OmniClean Spot Kit

PART NO.: **CLSPK** CASE QTY.: **1**

- Offset Pole with Actuator
- Small Bottle 0.5L
- Large Bottle 1L
- Pad Holder
- Microfiber Pads (2)
- DustPan Telescopic gray
- SmartColor Rectangular Labels (2)
- Carriage with Wringer
- Gray Bucket
- Gray Scrub Board
- Offset Tube Carriage Handle
- Gray Bucket Handle
- Excella Bottle Holder Clip
- DustPan Holder Clip
- Storage Bins (2)
- Storage Caddy
- Excella Clip
- Casters (4)



### Unger OmniClean Dual Bucket Kit - Offset

PART NO.: **CLBK2** CASE QTY.: **1**

- Offset Pole
- Pad Holder
- Microfiber Pads (2)
- SmartColor Rectangular Labels (2)
- Carriage with Wringer
- Gray Bucket (2)
- Blue StayClean Guide
- Gray Scrub Board
- Gray Bucket Handle
- Blue StayClean Bucket Handle
- Straight Carriage Handle
- Casters (4)



### Unger OmniClean Restroom Kit

PART NO.: **CLRRK** CASE QTY.: **1**

- Offset Pole with Actuator
- Small Bottle 0.5L
- Large Bottle 1L
- Pad Holder
- Microfiber Pads (2)
- DustPan Telescopic red
- Toilet Brush Handle w/ 2 brush heads
- NiftyNabber Red 18"
- SmartColor Rectangular Labels (2)
- Carriage with Wringer
- Gray Bucket
- Gray Scrub Board
- Offset Tube Carriage Handle
- Red Bucket Handle
- Excella Bottle Holder Clip
- DustPan Holder Clip
- Toilet Brush Holder Clip
- Nifty Nabber Holder Clip
- Storage Caddy
- Excella Clip
- Casters (4)

## ACCESSORIES



**Unger Excella  
Offset Pole with Actuator**

PART NO.: **EFPL1** CASE QTY.: **1**



**Unger Excella Offset Pole**

PART NO.: **EFPL2** CASE QTY.: **1**



**Unger Excella  
Straight Pole OmniClean**

PART NO.: **CLEF1** CASE QTY.: **1**



**OmniClean Mop Pad Holder**

PART NO.: **CLMPH** SIZE: **16"** CASE QTY.: **1**



**OmniClean  
Microfiber Pad (5)**

PART NO.: **CLMFP** SIZE: **16"** CASE QTY.: **1**

- Wash cycles: 300
- 7mm Pile



**Excella Bottles**

PART NO.: **EFBTS** SIZE: **0.5L** CASE QTY.: **6**

PART NO.: **EFBTL** SIZE: **1L** CASE QTY.: **6**



**Toilet Brush Handle  
with 2 Brush Heads**

PART NO.: **BBCOR** CASE QTY.: **5**



**Nifty Nabber Red**

PART NO.: **NN40R** SIZE: **18"** CASE QTY.: **5**



**DustPan Telescopic**

PART NO.: **EDTBR** COLOR: **Red** CASE QTY.: **6**

PART NO.: **EDTBG** COLOR: **Gray** CASE QTY.: **6**

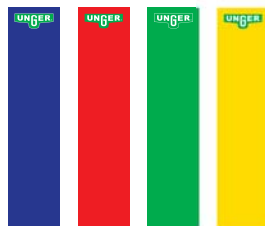

**SmartColor  
Rectangular Labels**

PART NO.: **SCCS0** CASE QTY.: **1**





**OmniClean Storage Bins**

PART NO.: 21460 CASE QTY.: 1



**OmniClean DustPan Holder Clip**

PART NO.: 21458 CASE QTY.: 1



**OmniClean Toilet Brush Holder Clip**

PART NO.: 21463 CASE QTY.: 1



**Nifty Nabber Holder Clip**

PART NO.: 17997 CASE QTY.: 1



**OmniClean Excella Clip**

PART NO.: 21805 CASE QTY.: 1

- For use with EFPL1



**OmniClean Dual Bottle Holder Clip**

PART NO.: 21457 CASE QTY.: 1



**OmniClean Storage Caddy**

PART NO.: 21462 CASE QTY.: 1



**OmniClean Pad Holder Replacement Adhesive Strips (3)**

PART NO.: 21614 CASE QTY.: 1



**OmniClean Gray Bucket**

PART NO.: 21375 CASE QTY.: 1



**OmniClean Bucket Handles**

PART NO.: 21526 COLOR: Blue CASE QTY.: 1  
 PART NO.: 21527 COLOR: Red CASE QTY.: 1  
 PART NO.: 21528 COLOR: Gray CASE QTY.: 1



**OmniClean Blue StayClean Guide**

PART NO.: 21387 CASE QTY.: 1



**OmniClean Gray Scrub Board**

PART NO.: 21533 CASE QTY.: 1



**OmniClean Carriage with Wringer**

PART NO.: 21483 CASE QTY.: 1



**OmniClean Carriage Handles**

PART NO.: 21572 HANDLE: Straight CASE QTY.: 1  
 PART NO.: 21484 HANDLE: Offset CASE QTY.: 1



**OmniClean Pad Holder End Clips (2)**

PART NO.: 21613 CASE QTY.: 1



**Casters**

PART NO.: 17891 CASE QTY.: 1