

Introducing Uvex Avatar™ So Comfortable, They'll Want Every Color.

Honeywell Uvex Avatar Designed with the worker in mind, our innovative technology allows for eight points of adjustability in this customizable, stylish eyewear. They'll think you had these made just for them, and you'll know your workers are safe.

Available in four colors and five different lens tints, there is a Uvex Avatar for every worker.

Uvex Avatar™

| PART NO. | FRAME COLOR | LENS TINT | COATING |
|----------|-------------|---------------|----------------|
| Avatar | | | |
| SZ850HS | BLACK | CLEAR | HYDROSHIELD AF |
| SZ851HS | BLACK | GRAY | HYDROSHIELD AF |
| SZ852HS | BLACK | AMBER | HYDROSHIELD AF |
| SZ854 | BLACK | SCITRELECT 50 | HARDPOINT |
| SZ855 | BLACK | BLUE MIRROR | HARDPOINT |
| SZ860HS | RED | CLEAR | HYDROSHIELD AF |
| SZ861HS | RED | GRAY | HYDROSHIELD AF |
| SZ863 | RED | BLUE MIRROR | HARDPOINT |
| SZ864 | RED | SCITRELECT 50 | HARDPOINT |
| SZ870HS | BLUE | CLEAR | HYDROSHIELD AF |
| SZ871HS | BLUE | GRAY | HYDROSHIELD AF |
| SZ873 | BLUE | BLUE MIRROR | HARDPOINT |
| SZ880HS | TEAL | CLEAR | HYDROSHIELD AF |
| SZ881HS | TEAL | GRAY | HYDROSHIELD AF |
| SZ883HS | TEAL | SCITRELECT 50 | HARDPOINT |
| SZ885 | BLACK | CLEAR | HARDPOINT |
| SZ886 | RED | CLEAR | HARDPOINT |
| SZ870 | BLUE | CLEAR | HARDPOINT |
| SZ860 | TEAL | CLEAR | HARDPOINT |



SZ850HS

SZ864

SZ873

SZ881HS

Uvex Avatar

Whether they work in manufacturing, utilities or construction, these customizable, stylish safety glasses are so comfortable, they'll forget they have them on.



For more information
www.uvex.us

Honeywell Uvex
900 Douglas Pike
Smithfield, RI 02837
800-430-5490
www.uvex.us

Doc / Rev / 4/17
© 2017 Honeywell International Inc.

Honeywell
UVEX

Introducing Uvex Avatar™





Uvex Avatar™

Unique technology for comfort in every color.

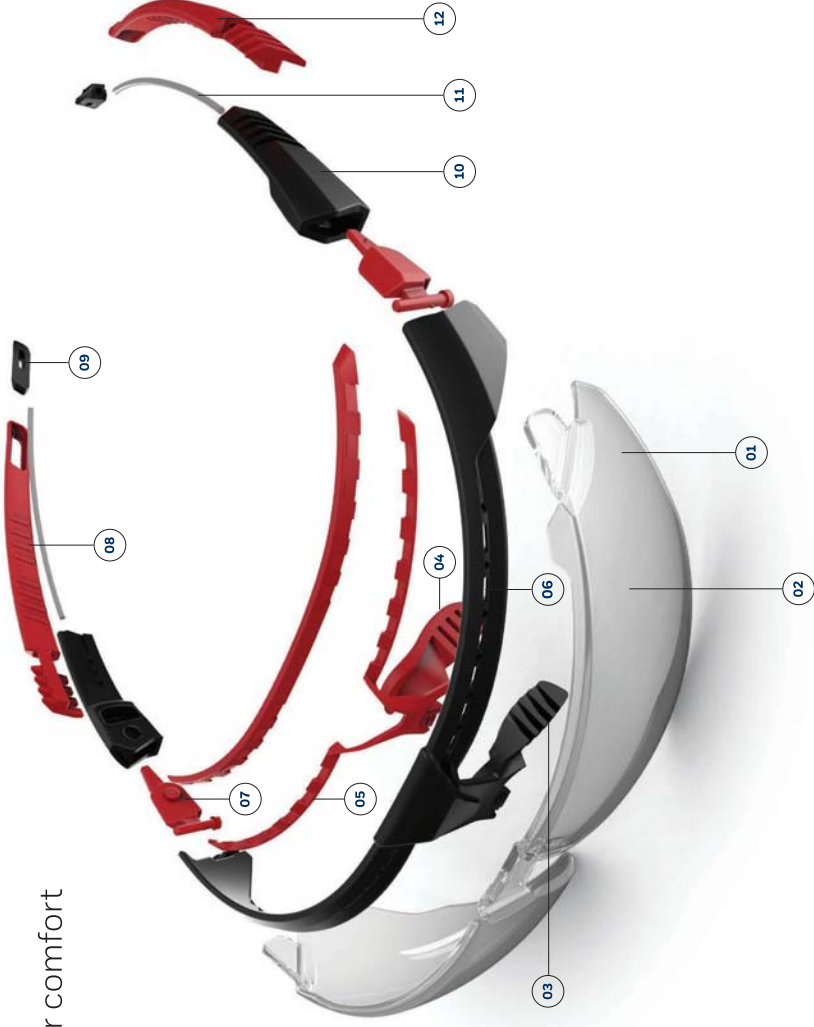

Honeywell Uvex Avatar™ features:

- 01 Uvex HydroShield™ Air & Hardcoat Coatings
- 02 9 Base Lens
- 03 Floating Nose Loop
- 04 Flexible Nose Pads
- 05 Soft Bow Frame--MMT+*
- 06 Indirect Venting System
- 07 Angle-Adjustable Ratchet Temples
- 08 Flexible Temples--MMT+*
- 09 Soft Temples & Nose Pads--MMT+*
- 10 Wire-Core Temples
- 11 Wrap-Around Temples & Soft Tip Pads--MMT+*
- 12 Ultra-Light Frame

*MMT+ Multi-Material Technology Plus

