





## Vortex ADA HS Hand Dryer

Is an energy efficient, surface-mounted and ADA compliant hand dryer. The VORTEX ADA hand dryer is perfect for all washrooms including those for disabled persons. Very stylish low-profile design with flexible cover options that fits any décor or washroom environment.

[Description](#) | [Short specs](#) | [Installation template](#) | [Warranty](#)

### • EXCLUSIVE 10 YEAR LIMITED WARRANTY

- Outstanding inside out coverage
- Exclusive Diamond prolonged warranty

### • INCOMPARABLE TECHNOLOGY

- Unique STERI-DRY germicidal bulb, eliminates 99.9% of bacteria & viruses
- Wi-Fi compatible
- Streamlined high efficiency low wattage motor
- Unique ceramic energy-conservation element

### • UNSURPASSED QUALITY

- Built and produced in North America
- Meticulous, one-of-a-kind quality control procedures
- Built to last and function even in the most challenging locations

### • STATE OF THE ART DESIGN

- Surface-mounted, Americans with Disabilities Act (ADA) compliant
- Easily harmonized with any design washroom
- Ideal for retrofitting existing, conventional high energy consuming hand dryers
- Classy, easy to clean surface

### • MATCHLESS CUSTOMER SERVICE

- Stand-by customer service attendants on line 24/7

### • UNEQUALLED DRYER ELEMENT

- Our specially developed ceramic element eliminates all possible loss of heat with the tight-fit orifice element compartment

### • SUPREME DESIGNER COLOR PALETTE

- Up-to-date in-stock designer color dryers with unequalised color options

## Related Products



**VORTEX ADA** **STERI-DRI™**  
High Speed  
hand dryer

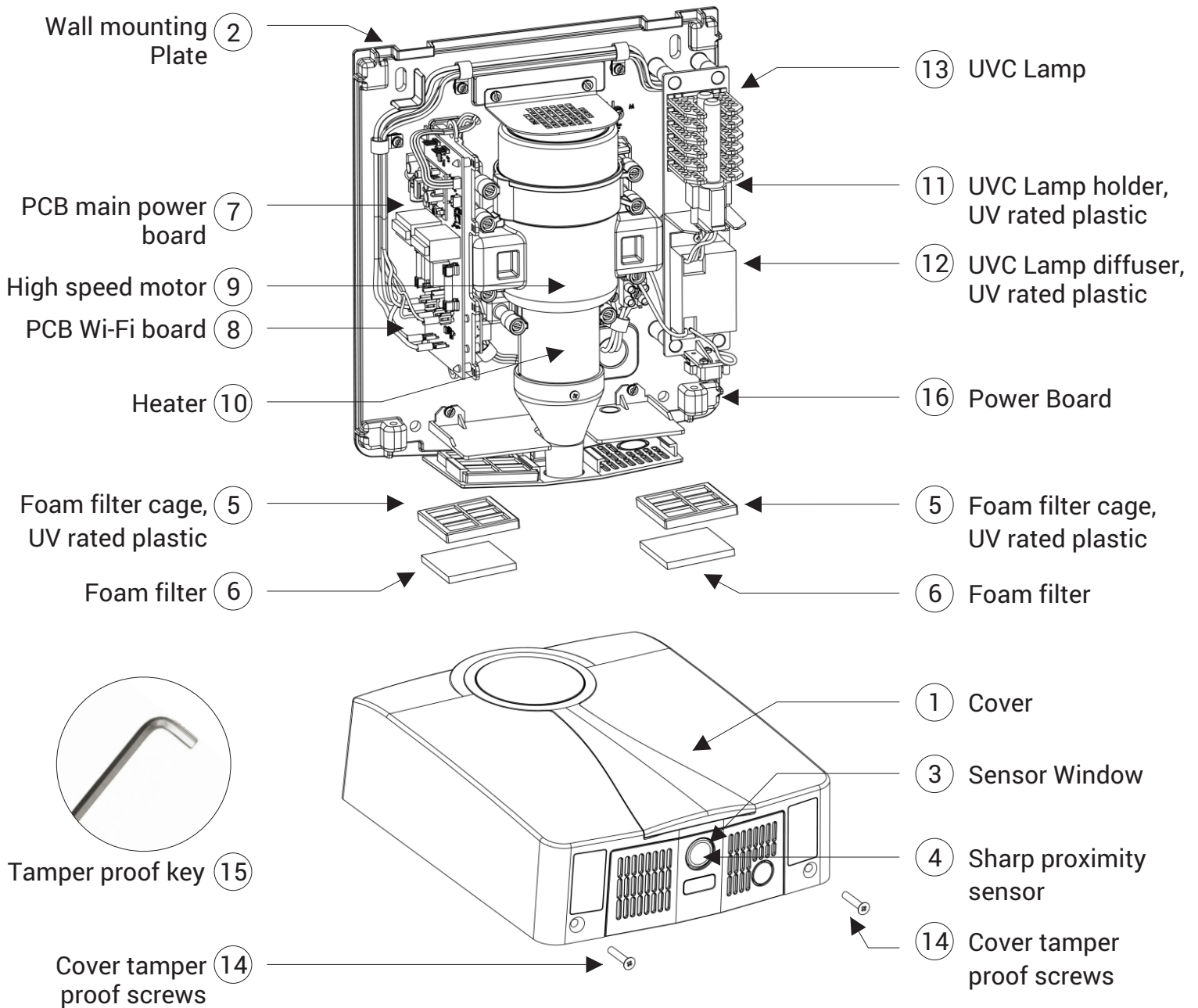

- 1.1.1.1 Mounting: surface-mounted.
- 1.1.1.2 Electrical Rating: (ADA HS) 1050 watts, 10 Amps, (110-120VAC, 50/60 Hz).
- 1.1.1.3 Electrical Rating: (ADA HS) 1050 watts, 5.2 Amps, (208-240VAC, 50/60 Hz).
- 1.1.1.4 Wi-Fi integrated technology can be monitored at distance for defaults such as motor and heater element failures.
- 1.1.1.5 Nozzle Type: single port for high intensity, focused dry.
- 1.1.1.6 Air Flow: 70 CFM at 246 mph (21648 LMF).
- 1.1.1.7 Intake Air Filter: coarse foam type air filter to capture lint and debris from air
- 1.1.1.8 *STERI-DRY™* germicidal technology UVC bulb
- 1.1.1.9 Motor: through-flow discharge vacuum type with automatic reset  
1.5 HP, 32,000 RPM.
- 1.1.1.10 Electronic Controls: automatic optical sensor. Operates while hands are under blower. Shut-off within 3 seconds when hands removed, or in 60 seconds if hands not removed.
- 1.1.1.11 Heater: nichrome wire element mounted inside ceramic housing with dual level safety protection - automatic resetting thermostat to open when air flow is restricted and close when air flow is resumed with back-up one use thermal cutoff. Heated air temperature is 111 degrees F (44 degrees C) at an ambient of 70 degrees F (21 degrees C).
- 1.1.1.12 Warranty: 10-year manufacturer limited warranty (not including replaceable filters or germicidal bulb).
- 1.1.1.13 Sound Level: 86 dBA at operator with hands; 65 dBA at 39.5 inches (1 meter), no hands.
- 1.1.1.14 Anti-microbial features inhibit the growth of bacteria, mold and fungus, extending the dryer's service life.
- 1.1.1.15 Cover Material: one piece, heavy duty, die-cast aluminum.
- 1.1.1.16 Weight & dimensions, weight 4.757kg (10 ½lbs) (width 287.02mm (11.3") x height 334.50mm (13.17") x depth 100.59mm (3.96"))

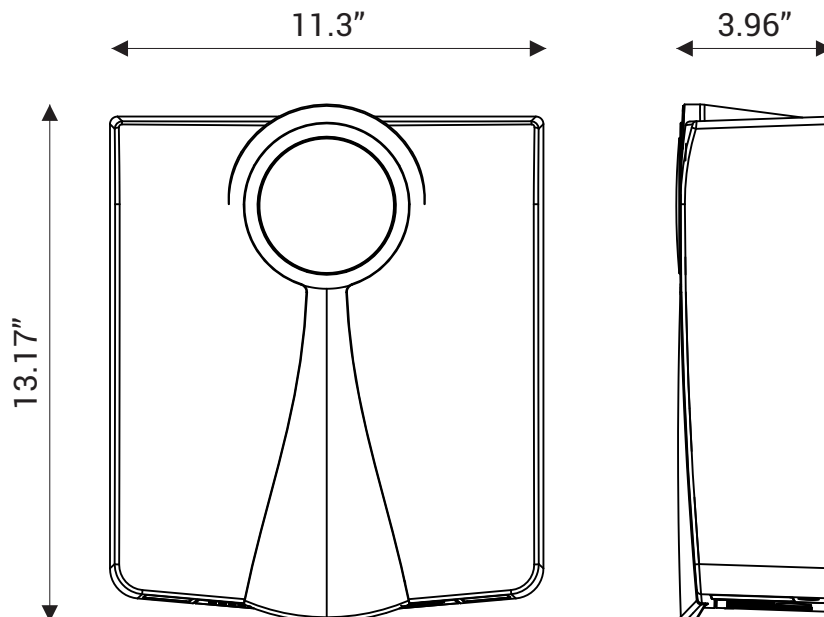

MODEL	COLOR	VOLTAGE	SKU
VHSA1BLK	BLACK	110-120VAC	769498991657
VHSA2BLK	BLACK	208-240VAC	769498991718
VHSA1WHT	WHITE	110-120VAC	769498991701
VHSA2WHT	WHITE	208-240VAC	769498991763
VHSA1CHA	CHARCOAL	110-120VAC	769498991664
VHSA2CHA	CHARCOAL	208-240VAC	769498991725
VHSA1CHR	CHROME	110-120VAC	769498991671
VHSA2CHR	CHROME	208-240VAC	769498991732
VHSA1RED	DARK RED	110-120VAC	769498991695
VHSA2RED	DARK RED	208-240VAC	769498991756
VHSA1CUS	CUSTOM	110-120VAC	769498991688
VHSA2CUS	CUSTOM	208-240VAC	769498991749



## Vortex Industries Inc.

2501 Dollard Avenue | LaSalle, Qc. Canada H8N 1S2  
 1-844-9VORTEX | WWW.VORTEXDRYERS.COM